

LABEL L1 LOCKING LUG  
1:5 -- 2 OFF REQUIRED/CAGE  
5mm M/S FLAT  
CUT TO DETAILS

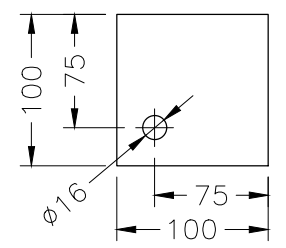
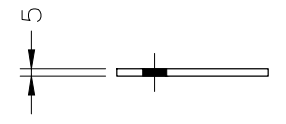

LABEL BP1 BASE PLATE  
1:5 -- 4 OFF REQUIRED/CAGE  
5mm M/S FLAT  
CUT TO DETAILS

LABEL SC1 SECURITY CAGE  
1:16 -- - OFF REQUIRED  
50x50x2.5 GALV SHS FRAMING  
50x50x4.0 GALV WELDMESH INFILL  
5mm BASE PLATES/M10 DYNABOLTS  
HINGED LID/PADLOCKABLE

50x50x4 GALV WELDMESH. TOP/ALL SIDES

OPEN BOTTOM

PADLOCKABLE

# SAXON ENGINEERING

23 HEATH STREET LONSDALE  
SOUTH AUSTRALIA 5160  
AUSTRALIA. Ph 08 8187 2888. Fax 08 8326 8654  
EMAIL. sales@saxonengineering.com.au  
admin@saxonengineering.com.au

THIS DOCUMENT IS COPYRIGHT AND REMAINS THE PROPERTY OF SAXON ENGINEERING, AND MUST NOT BE USED, REPRODUCED OR COPIED, WHOLLY OR IN PART, WITHOUT THE WRITTEN PERMISSION OF SAXON ENGINEERING.

REV	DESCRIPTION	DATE
0	ISSUE FOR APPROVAL	27/07/20

TITLE: RPZ SECURITY CAGE DETAILS				
SITE:				
CLIENT: SA WATER SPEC				
SCALE (S) AS SHOWN			JOB No: 01	
DRAWN	CHECKED	SIZE	DRAWING NUMBER	REV.
27/07/20		A3	SAW-RPZ-01	0